

T500  
A2 R142

# DIAGRAMS

OF

# World's Fair Buildings

SHOWING

LOCATION OF EXHIBITS

---

Compliments of . . .

Otis Brothers & Co.

NEW YORK,

Hale Elevator Co. \_\_\_\_\_

CHICAGO,

41896 y'

Otis Elevator Co. (Ltd.)

LONDON, ENGLAND,

Austral-Otis Elevator Co.

MELBOURNE AND SIDNEY, AUSTRALIA.

# OTIS BROTHERS & Co.

## NEW YORK.

WASHINGTON

BOSTON

ATLANTA

PHILADELPHIA

SAN FRANCISCO

PITTSBURG

PORTLAND

---

# HALE ELEVATOR Co.

## CHICAGO.

ST. LOUIS

DETROIT

MINNEAPOLIS

CLEVELAND

NEW ORLEANS

---

# OTIS ELEVATOR Co. (LTD.)

## LONDON.

PARIS

BERLIN

ST. PETERSBURG

AMSTERDAM

STOCKHOLM

---

ROME

# AUSTRAL-OTIS

## ELEVATOR Co.

MELBOURNE, }  
SIDNEY, } AUSTRALIA.

COMPLIMENTS OF

✓  
Otis Brothers & Co.,  
NEW YORK,

Hale Elevator Co., —  
CHICAGO,

Otis Elevator Co., Limited,  
LONDON, ENGLAND.

15  
—  
9180<sup>a</sup>

DIAGRAMS

OF

WORLD'S FAIR BUILDINGS,

SHOWING

LOCATION OF EXHIBITS,

CHICAGO, 1893.

**EIGHT OTIS ELECTRIC PASSENGER ELEVATOR  
ENGINES IN THIS BUILDING.**



ADMINISTRATION BUILDING.

T. 577  
A2. R142

# OTIS BROTHERS & CO.

LOCATION OF OTIS ELEVATORS ON WORLD'S FAIR GROUNDS SHOWN  
BY FIGURES ON MAP.

## TRANSPORTATION BUILDING.

Central Tower, Eight Hydraulic Passenger Elevators free to Gallery.

## TRANSPORTATION BUILDING.

West Aisle, Columns 16 and 17, Section D, World's Fair Office, General Exhibit, Electric Passenger Elevators, Compound Steam Elevator, Electric Elevator FREE to Gallery, Electric Pumps, etc.

## MANUFACTURES BUILDING.

North End, Four Electric Passenger Elevators running to the Highest Roof Promenade in the World.

## CASINO BUILDING.

Two Hydraulic Passenger, one Hydraulic Freight Elevator, and two Hydraulic Direct-acting Dumb-waiters, installed by Hale Elevator Company.

## ADMINISTRATION BUILDING.

Eight Otis Electric Passenger Elevator Engines.

All of the OTIS ELEVATORS on the World's Fair Grounds are doing useful work, and can be seen in operation under the demands of every-day use.



# OTIS-HALE ELEVATOR.

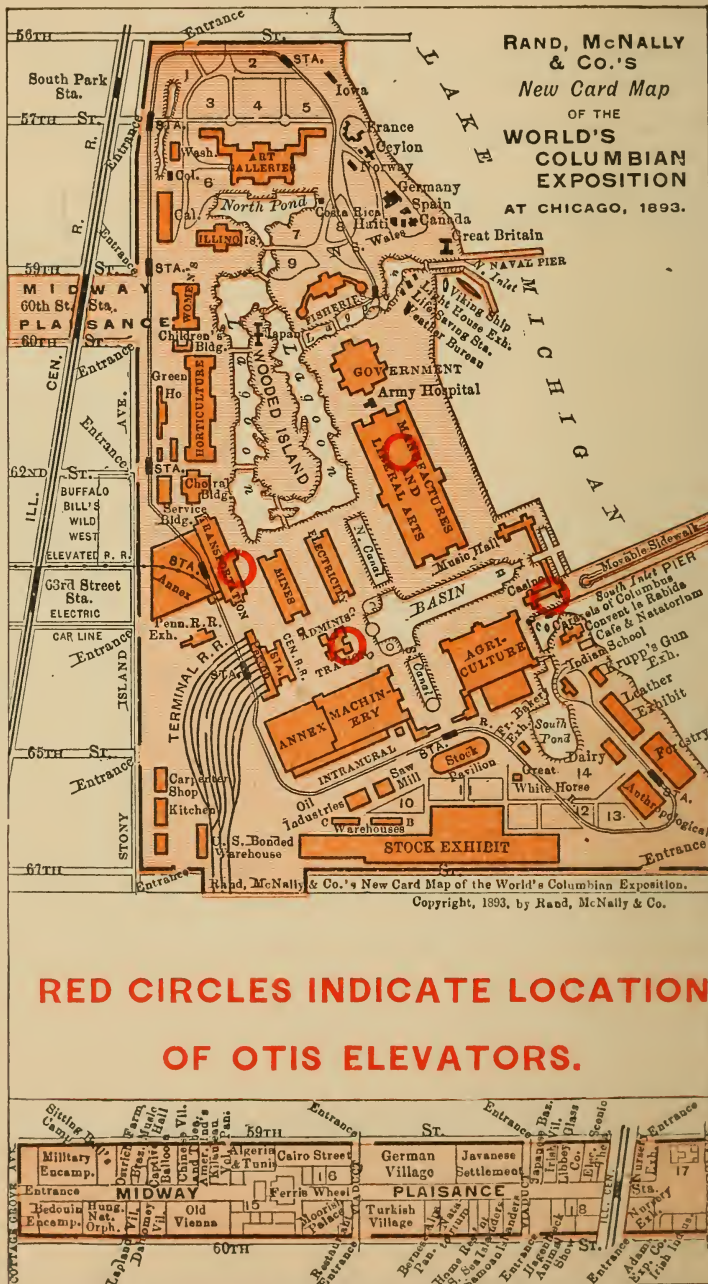

LAGOON

LAGOON

LANDING

BRIDGE

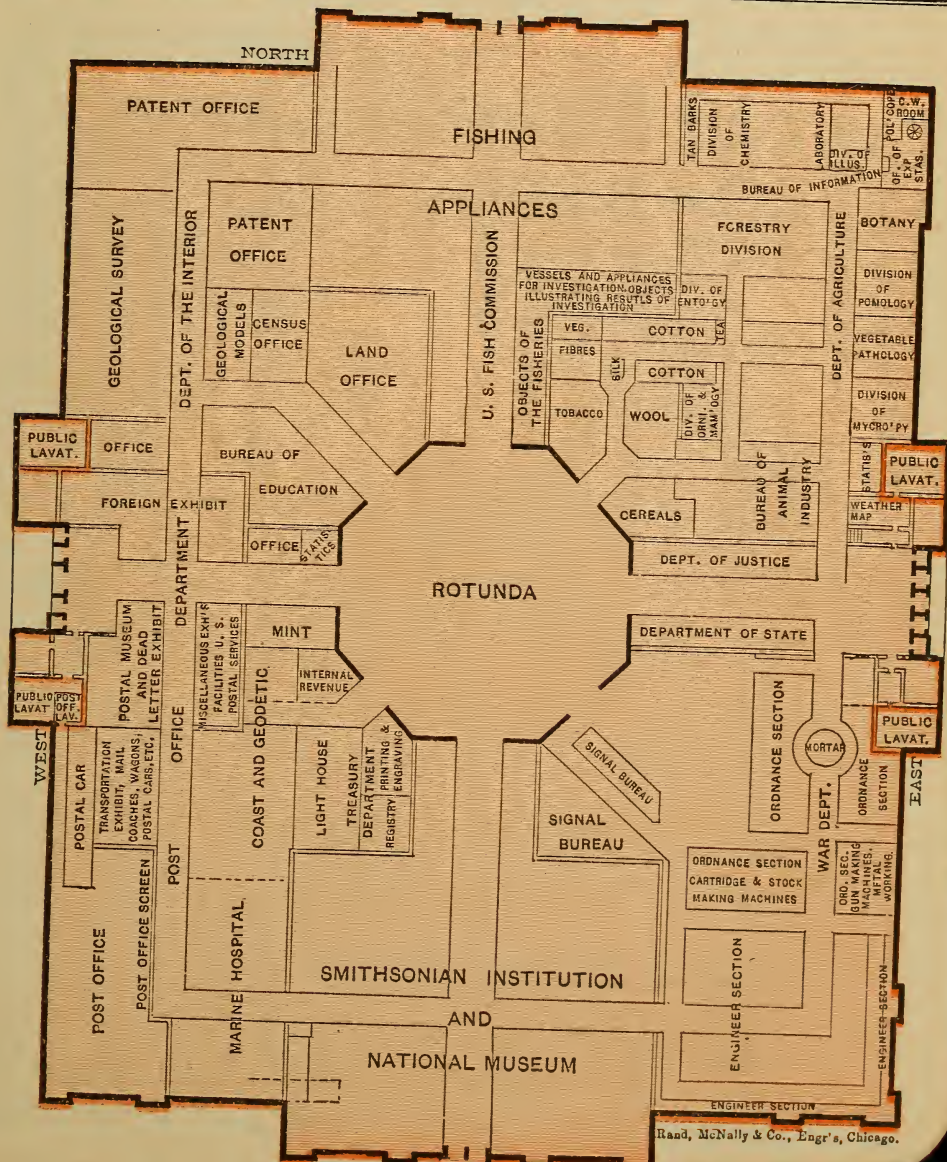



L A K E M I

# FOUR OTIS-HALE ELECTRIC PASSENGER

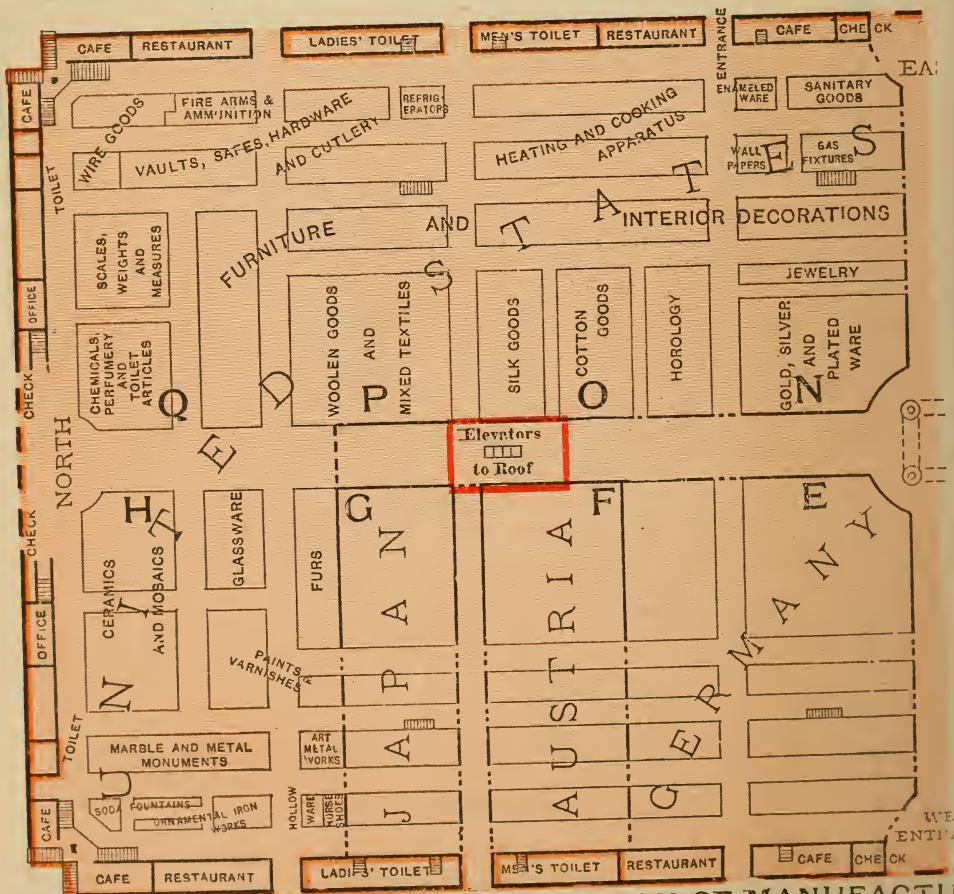

GROUND FLOOR PLAN OF MANUFACTURE  
 A MAGNIFICENT BIRDS-EYE VIEW OF THE GROUNDS,  
 OBTAINED FROM



C H I G A N

## ELEVATORS TO ROOF PROMENADE.

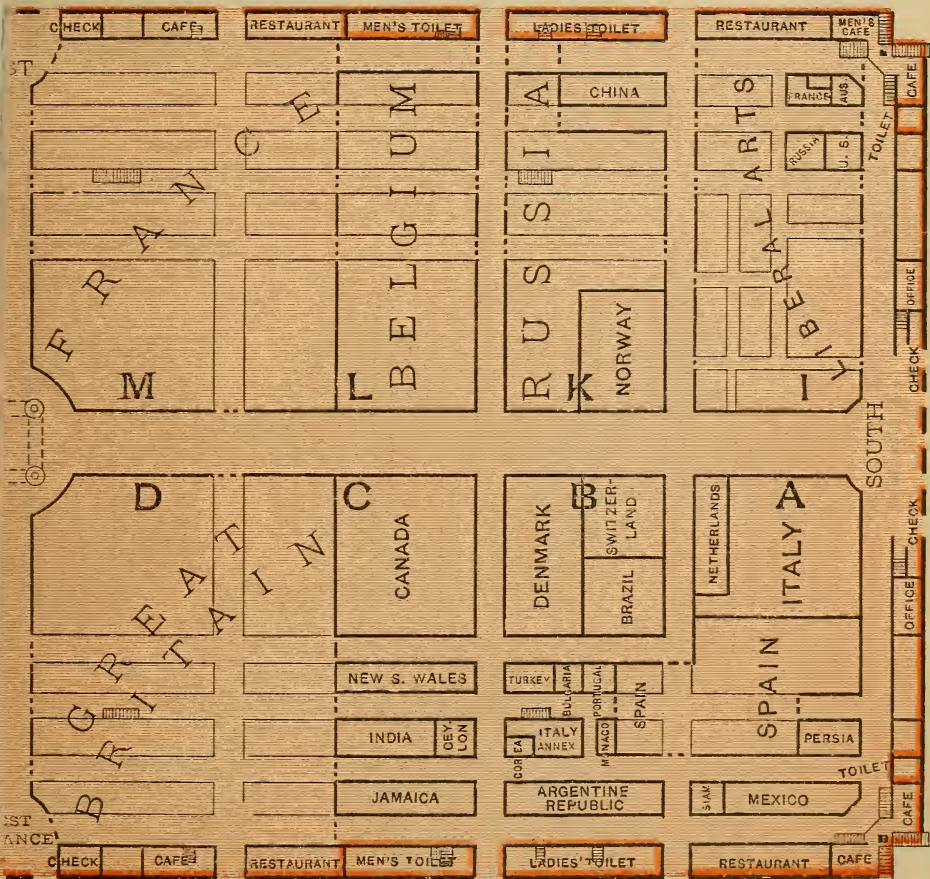

WOMEN'S AND LIBERAL ARTS BUILDING.

BUILDINGS AND SURROUNDING COUNTRY MAY BE  
THIS POINT.

Bridge

NORTH CANAL

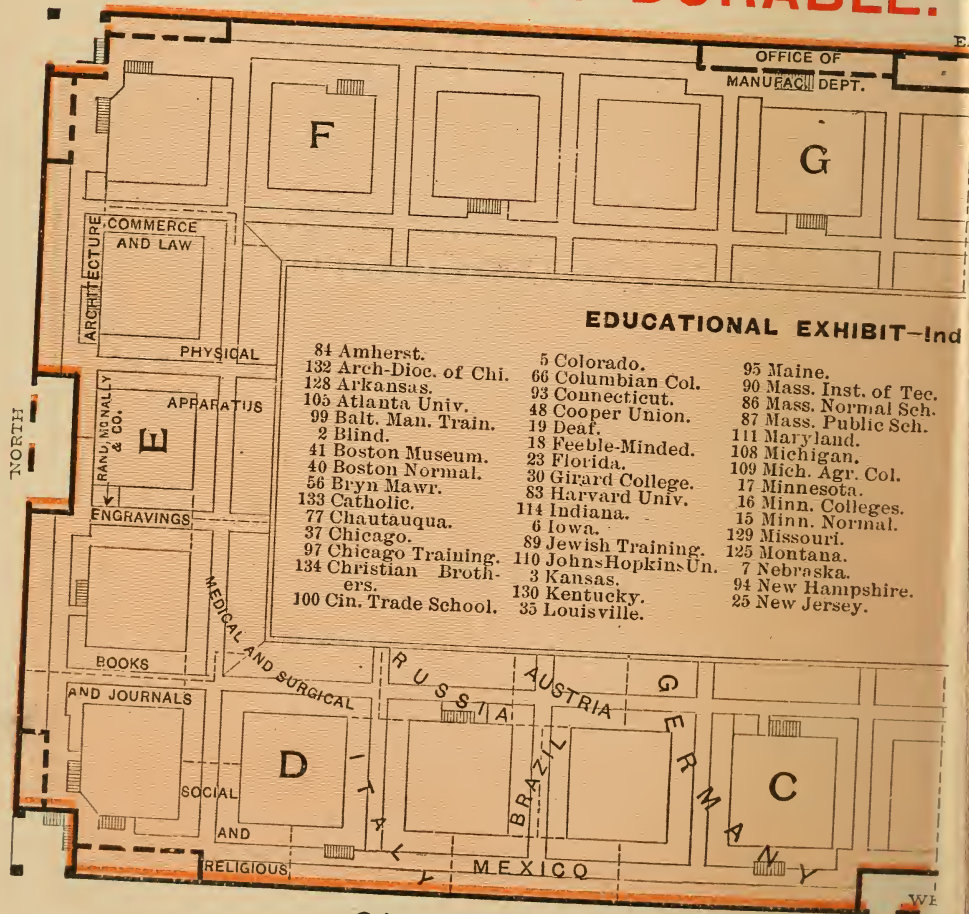

# GALLERY PLAN OF MANUFACTUR

YOU WILL FIND THEM



# MOST EFFICIENT.

ST

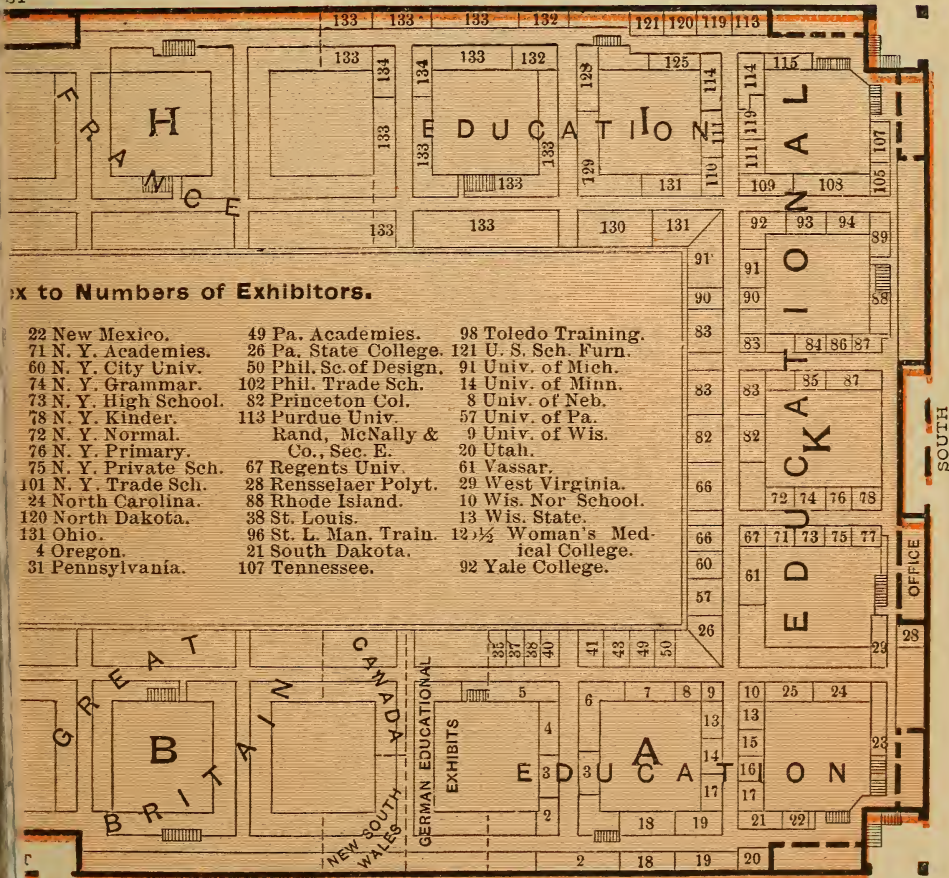

S AND LIBERAL ARTS BUILDING.

# ALL OVER THE WORLD.



# OTIS BROTHERS & CO., NEW YORK.

BASIN

BASIN

LANDING

NORTH

MEN'S  
TOILETLADIES'  
TOILET

DOME

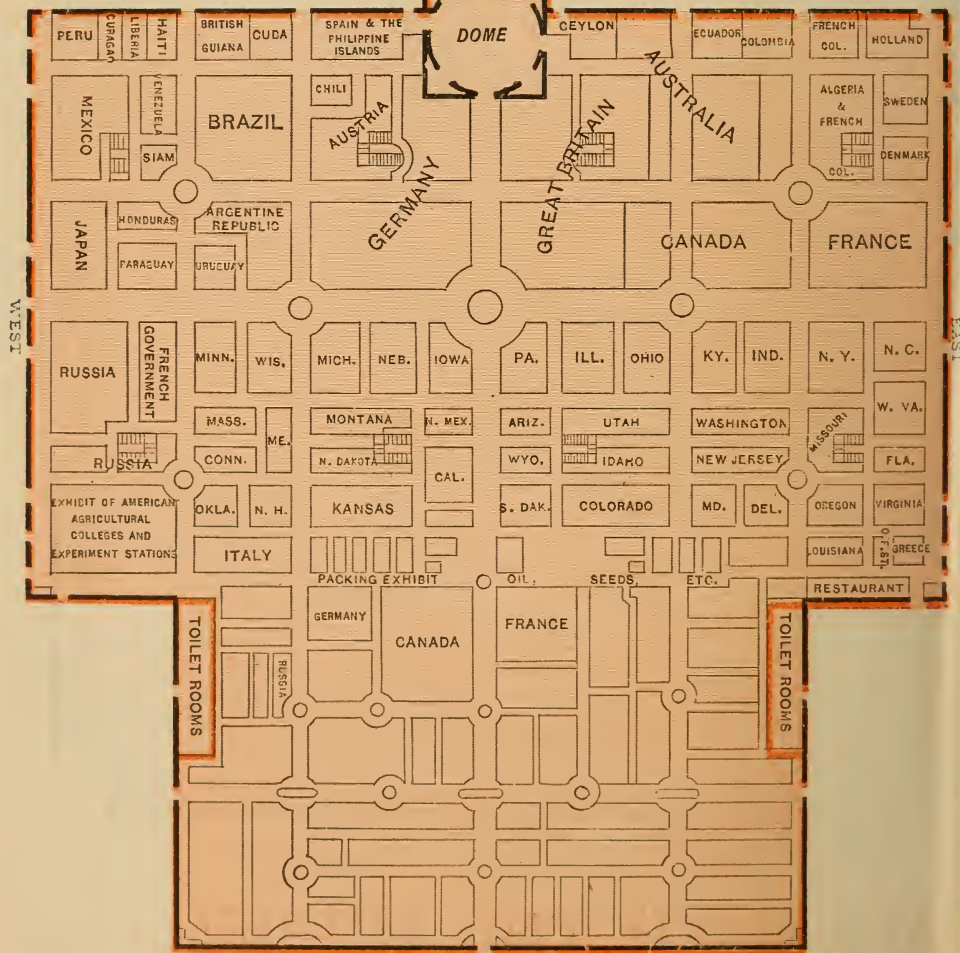

GROUND PLAN OF AGRICULTURAL BUILDING AND ANNEX.

# HALE ELEVATOR CO., CHICAGO.

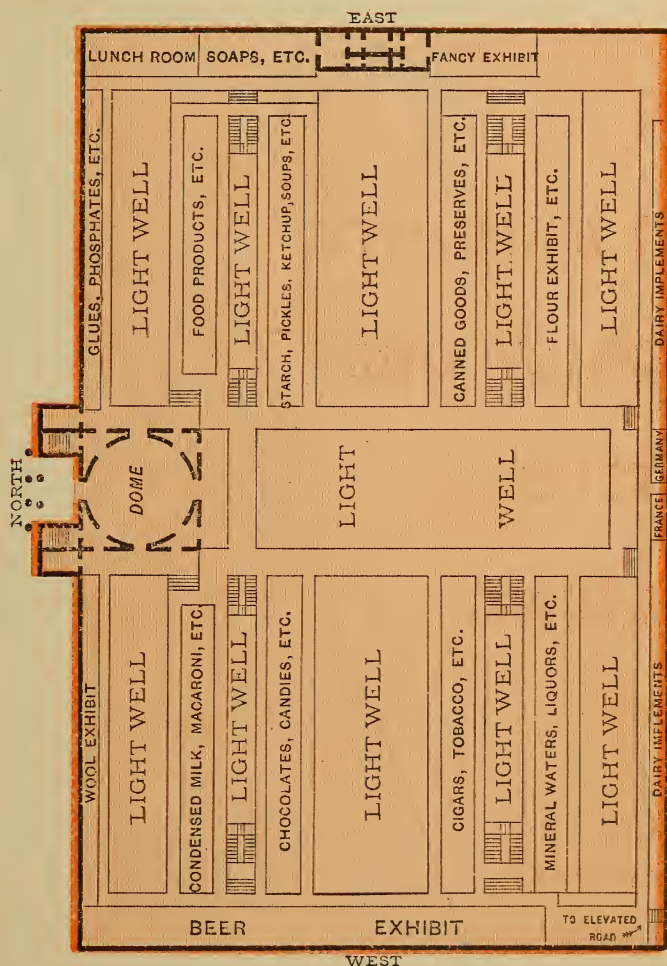

GALLERY PLAN AGRICULTURAL BUILDING.

OTIS ELEVATOR CO. (LTD.)  
LONDON, ENG.

SEE

OUR EXHIBITS

IN DAILY USE

IN THIS

BUILDING.

WEST AISLE,

COLUMNS

16 AND 17

ALSO CENTRAL

TOWER.

United States.....A  
Germany.....B  
France.....C  
Austria.....D  
Great Britain.....E  
Canada.....F  
Mexico.....G  
Spain.....H  
Russia.....I  
Brazil.....J





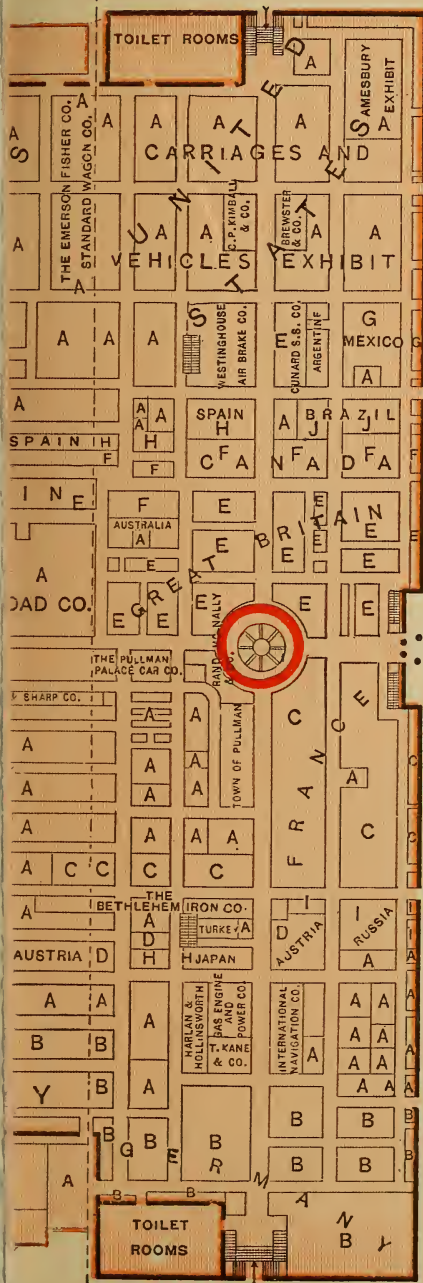

MAIN OR GROUND FLOOR OF TRANSPORTATION BUILDING  
AND ANNEX.

## EIGHT HYDRAULIC PASSENGER ELEVATORS

FREE TO GALLERY.

THE "OTIS" FREE ELECTRIC ELEVATOR  
TO THE GALLERY OF TRANSPORTATION BUILDING.

WEST AISLE, COLUMNS 16 AND 17, SECTION D.

OTIS FREE ELECTRIC ELEVATOR

RUNS TO THE GALLERY IN TRANSPORTATION BUILDING.

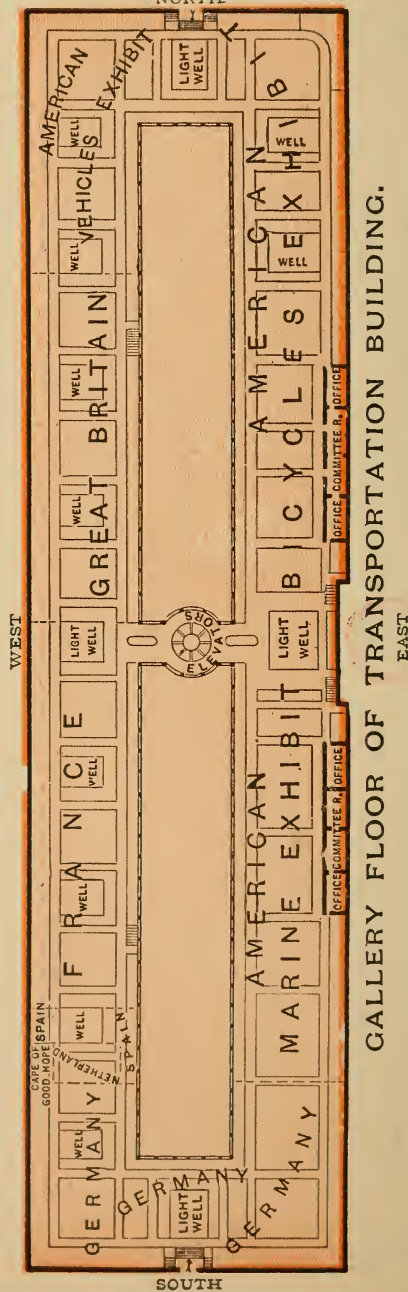

GALLERY FLOOR OF TRANSPORTATION BUILDING.

TAKE ELEVATORS IN WEST AISLE,

COLUMNS 16 AND 17, SECTION D.

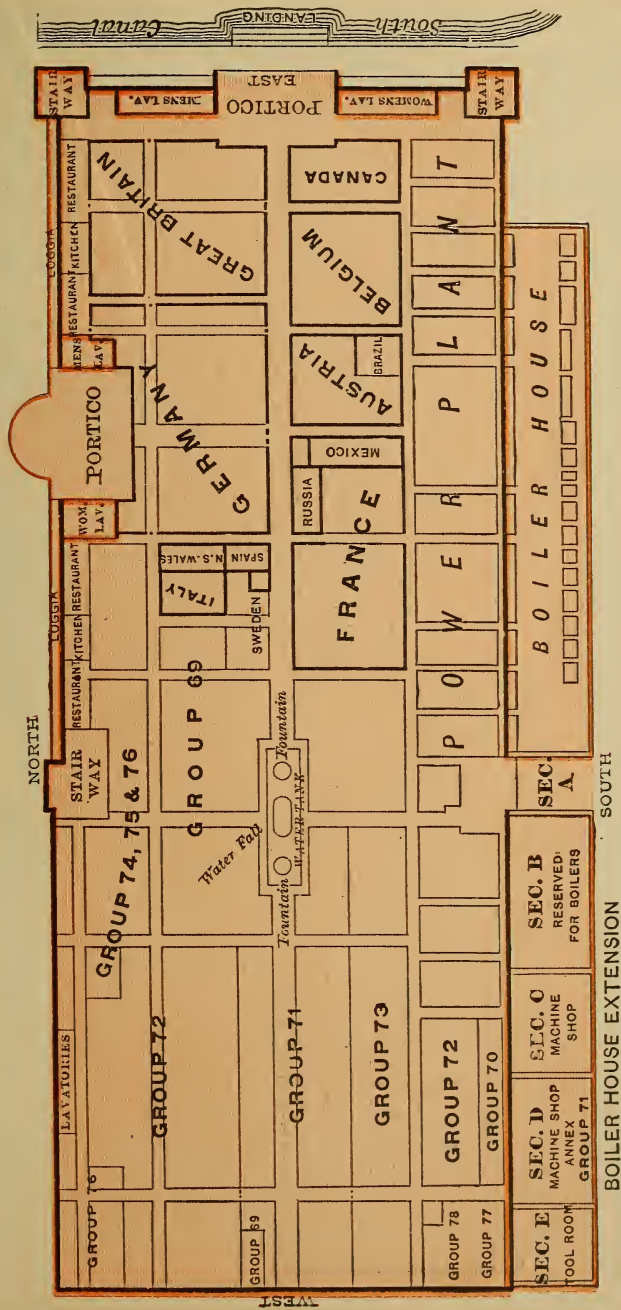

## GROUND PLAN OF MACHINERY HALL AND ANNEX.

- 69 Hydraulic and Pneumatic Apparatus.
- 70 Fire Extinguishing Apparatus.
- 71 Metal Working Machines and Tools.
- 72 Machinery for Textile and Clothing Industries.
- 73 Wood Working Machines.
- 74 Typographical, Bookmaking, and Paper Working Apparatus.

- 75 Color Printing, Lithography, and Zincography.
- 76 Mechanical Processes of Illustrating.
- 77 Miscellaneous Machines, Apparatus and Hand Tools.
- 78 Stone, Clay, and other Mineral Working Machines.
- 79 Machinery for Preparing Foods, etc.



## ELECTRICITY BUILDING

## GROUND PLAN.

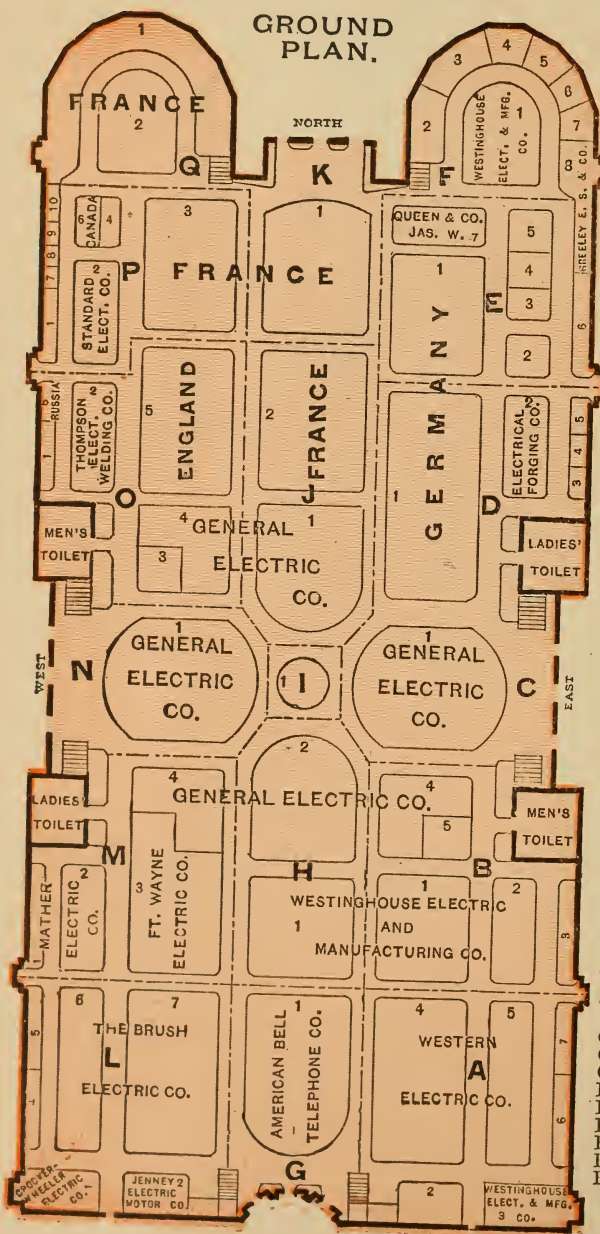

A 2 "C. & C." Electric Motor Co.

A 3  
B 1-2 Westinghouse Electric & Mfg. Co.  
F 1  
H 1

A 4-5 Western Electric Co.  
A 7 Taylor, Goodhue & Ames.

B 3 Eddy Electric Mfg. Co.

B 4  
C 1  
H 2  
J 1 General Electric Co.  
M 4  
N 1

O 3  
B 5 Excelsior Electric Co.  
D 1  
E 1 Germany.

D 2 Electrical Forging Co.  
D 3 Schieren & Co., Chas. A.  
D 4 Munson Belting Co.  
D 5 Page Belting Co.  
E 2 Belknap Motor Co.  
E 3 Elwell-Parker Electric Const. Co.

E 4 Arnold Mfg. Co.  
E 5 Mather, A. C.  
E 7 Queen & Co., Jas. W.  
F 2 Zucker & Levett Chemical Co.

F 3 Union Electric Co.  
F 4 Commercial Elect. Co.  
F 5 Chicago Belting Co.  
F 6 Jewell Belting Co.  
F 7 Curtis Elect. Mfg. Co.  
F 8 Greeley, E. S. & Co.  
G 1 American Bell Telephone Co.

I 1 Phenix Glass Co.

J 2  
K 1 France.  
P 3

Q 1-2  
L 1 Crocker-Wheeler Electric Co.

L 2 Jenney Electric Motor Co.

L 4 Hansen & Van Winkle Co.

L 5 Degenhardt, F. F.  
L 6-7 Brush Elect. Co., The  
M 12 Mather Electric Co.

M 3 Fort Wayne Elect. Co., E. A. Barnes.

O 2 Thompson Elect. Welding Co.

O 4 Heislner Electric Co.

O 5 England.

O 6 Russia.

P 1 Electrical Conduit Co.

P 2 Standard Electric Co.

P 4 Electron Mfg. Co.

P 6 Canada.

P 9 Elliott Elect. Co.

P 10 Wing, L. J. & Co.

OTIS BROTHERS & CO., NEW YORK.

HALE ELEVATOR CO., CHICAGO.

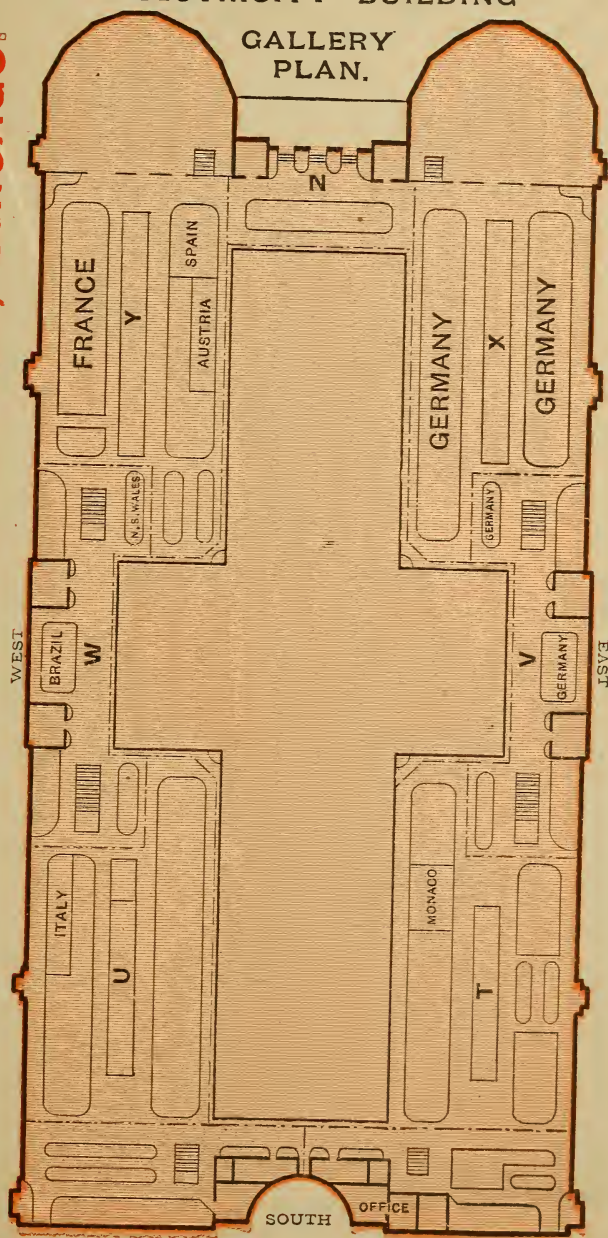

DON'T FAIL TO SEE THE

OTIS ELECTRIC PUMP.

# OTIS-HALE ELEVATOR.

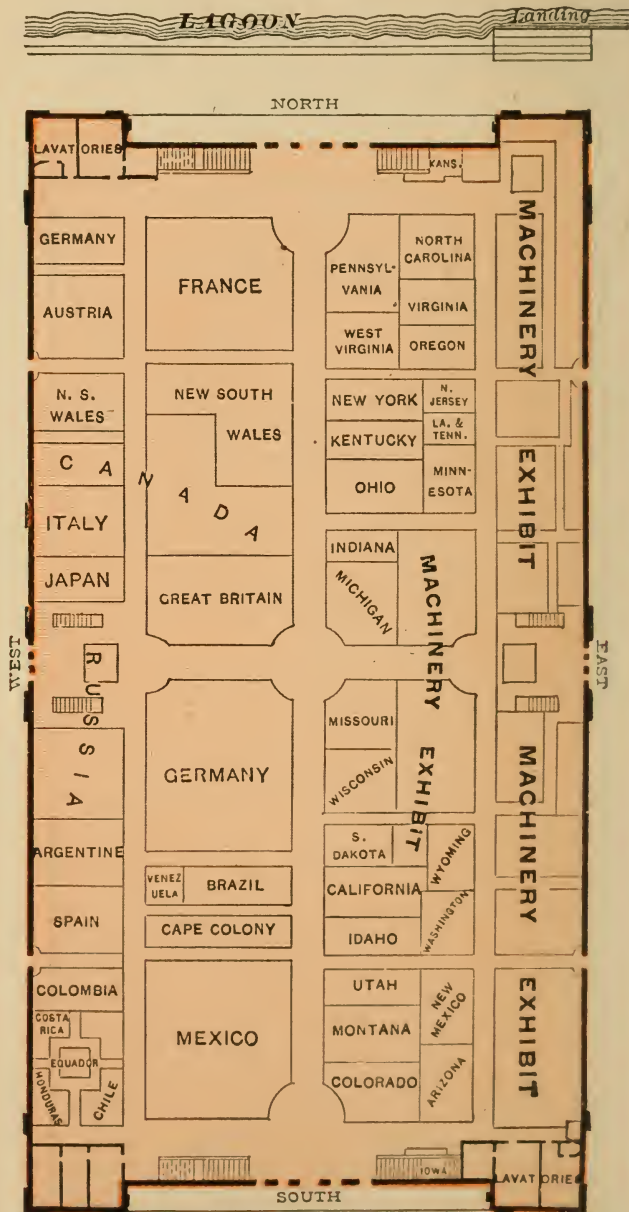

GROUND PLAN  
MINES AND MINING BUILDING.

SAFEST, MOST DURABLE, AND MOST EFFICIENT



DON'T MISS THE VIEW FROM THE TOP  
OF MANUFACTURES BUILDING.

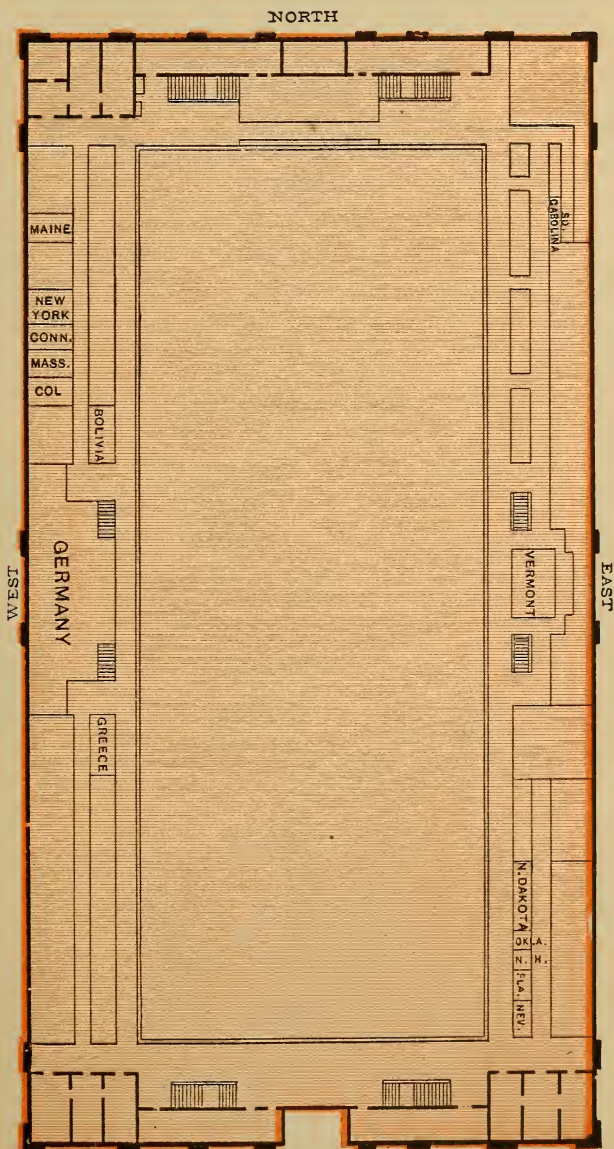

GALLERY PLAN  
MINES AND MINING BUILDING.

THE HIGHEST ROOF PROMENADE IN THE WORLD.



NORTH

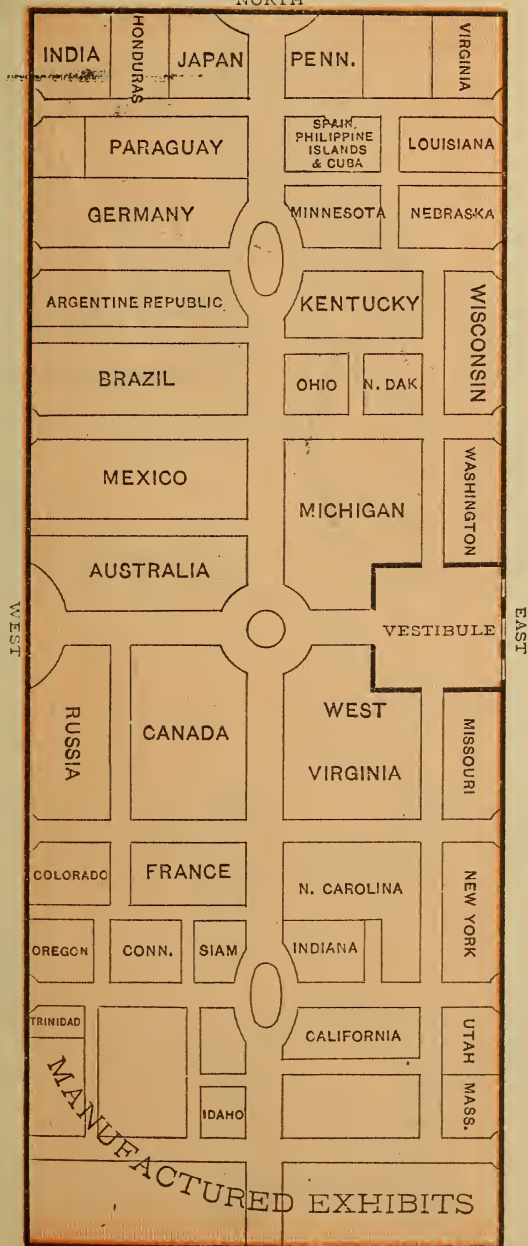

T A K E M I C H I G A N

OTIS ELEVATOR CO. (LTD.)

LONDON, ENG.

GROUND PLAN FORESTRY BUILDING.



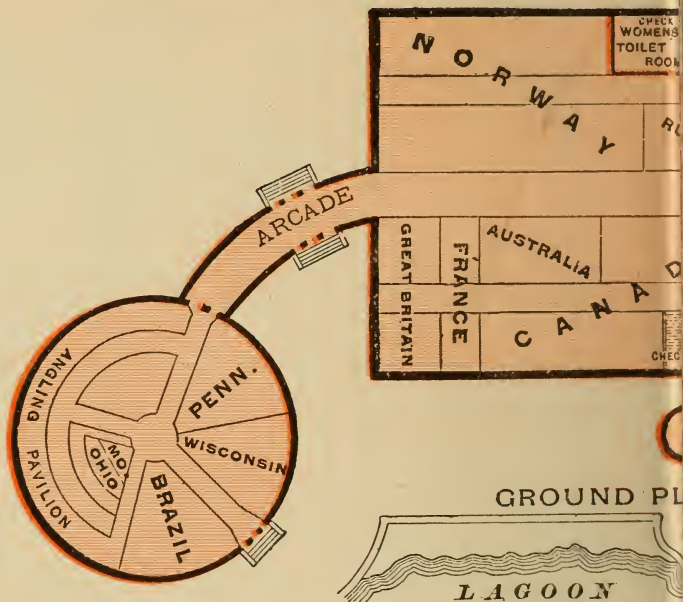

## HALE ELEVATOR CO., CHICAGO.

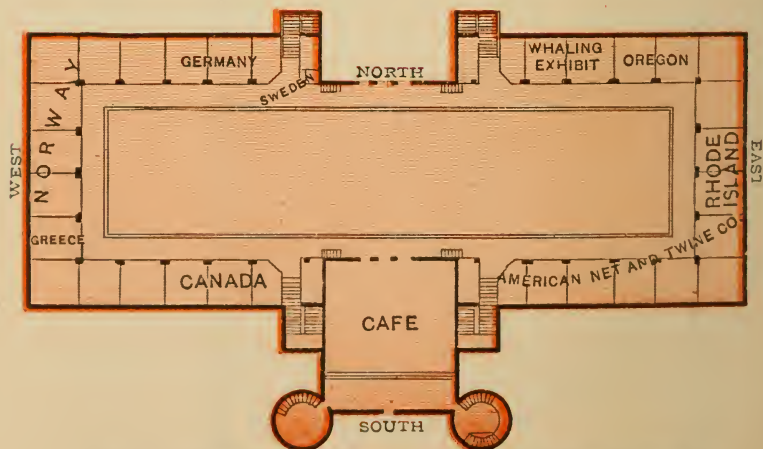

GALLERY PLAN FISHERIES BUILDING.

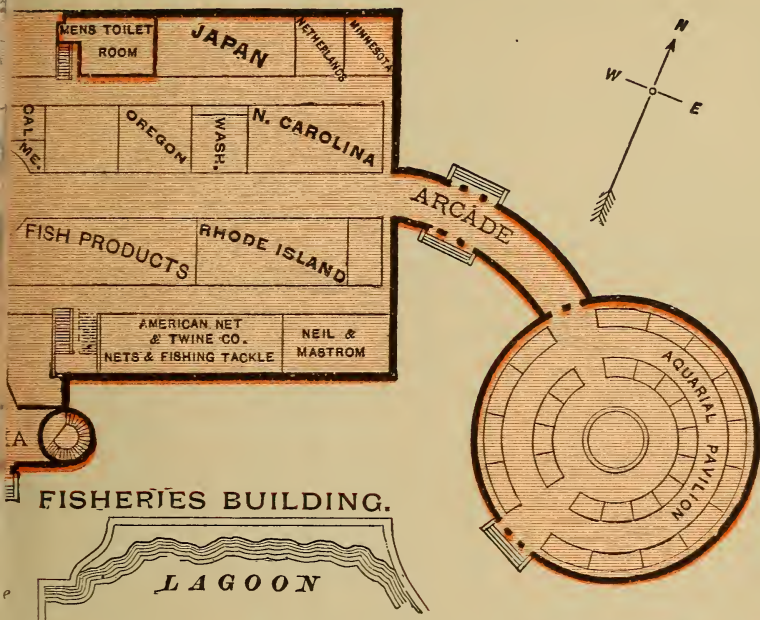

# OTIS BROTHERS & Co.

HYDRAULIC, STEAM, AND  
ELECTRIC ELEVATORS,

**ELECTRIC PUMPS.**

*VISIT EXHIBITS IN TRANSPORTATION BUILDING.*

WEST AISLE, COLUMNS 16 AND 17, SECTION D.

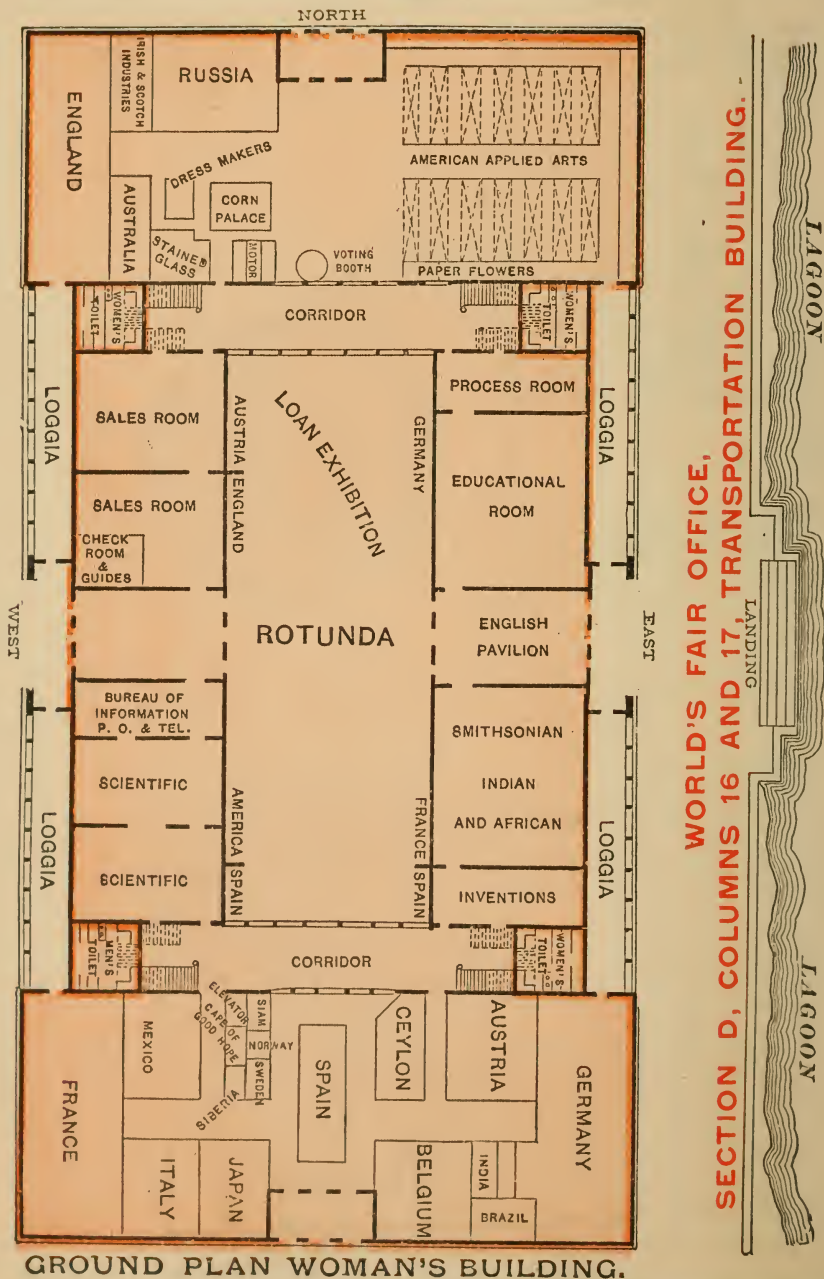



OTIS ELEVATOR CO. (LTD.), LONDON, ENG.  
 OTIS BROTHERS & CO., NEW YORK.  
 HALE ELEVATOR CO., CHICAGO.

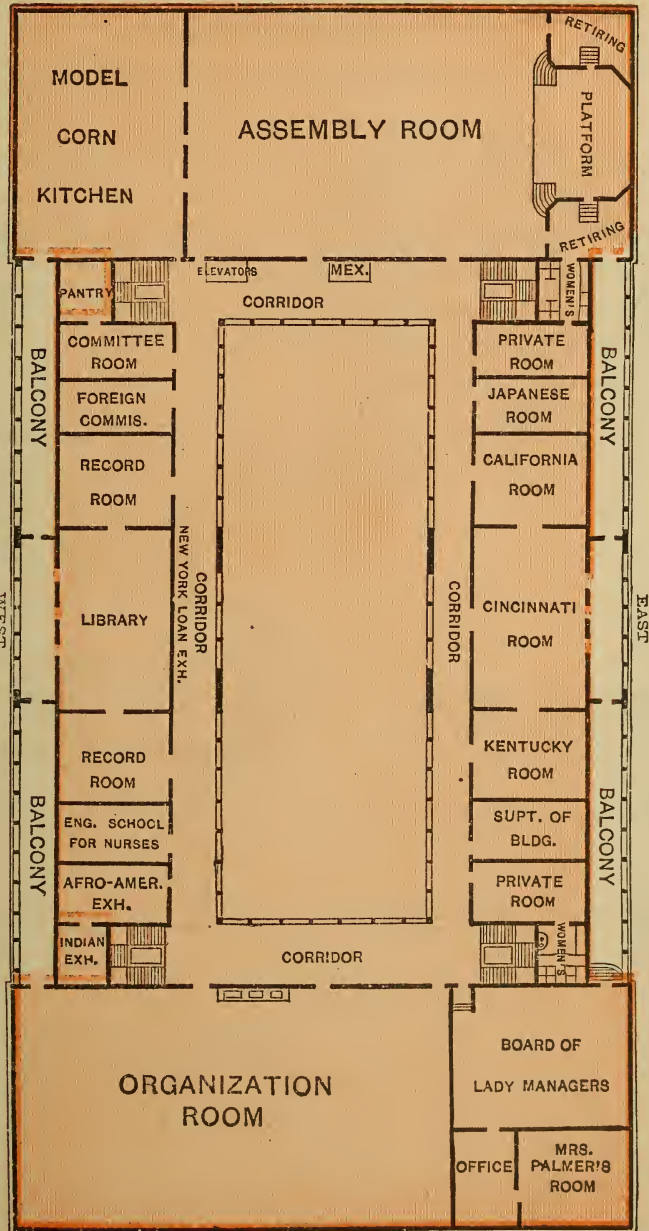

GALLERY PLAN WOMAN'S BUILDING.

OTIS FREE ELECTRIC ELEVATOR

RUNS TO THE GALLERY IN TRANSPORTATION BUILDING.

# OTIS ELEVATING RAILWAY TO SUN

LENGTH, 7,000 FEET. RISE, 1,600 FEET.

MAKING THE ASCENT



## GROUND PLAN FINE ARTS BUILDING



### Index to Fine Arts Building.

Italy,	Sections 60, 61, 76 to 80.
Japan,	" 24.
Norway,	" 71, 72.
Poland,	" 62.
Russia,	" 19, 20.
Spain,	" 21 to 23,
Sweden,	" 68 to 70.
United States,	" 1 to 9, 37 to 42.

NORTH

SEE PHOTOGRAPHS IN THE TRANSPORTATION BUILDING

# T OF CATSKILL MOUNTAINS.

PACITY, 100 PERSONS AND BAGGAGE.

EIGHT MINUTES.

B BUILDING.

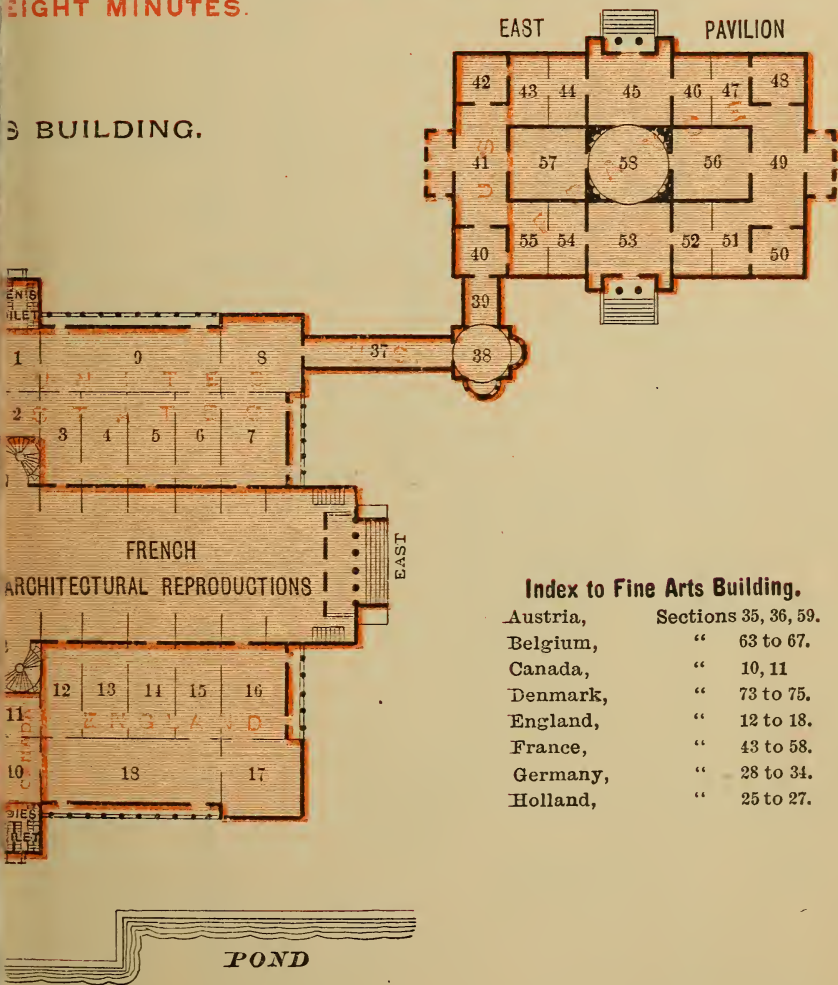

## Index to Fine Arts Building.

Austria,	Sections 35, 36, 59.
Belgium,	" 63 to 67.
Canada,	" 10, 11
Denmark,	" 73 to 75.
England,	" 12 to 18.
France,	" 43 to 58.
Germany,	" 28 to 34.
Holland,	" 25 to 27.

UMNS 16 AND 17, SECTION D, WEST AISLE.



**DON'T FAIL TO SEE THE  
OTIS ELECTRIC PUMP.**

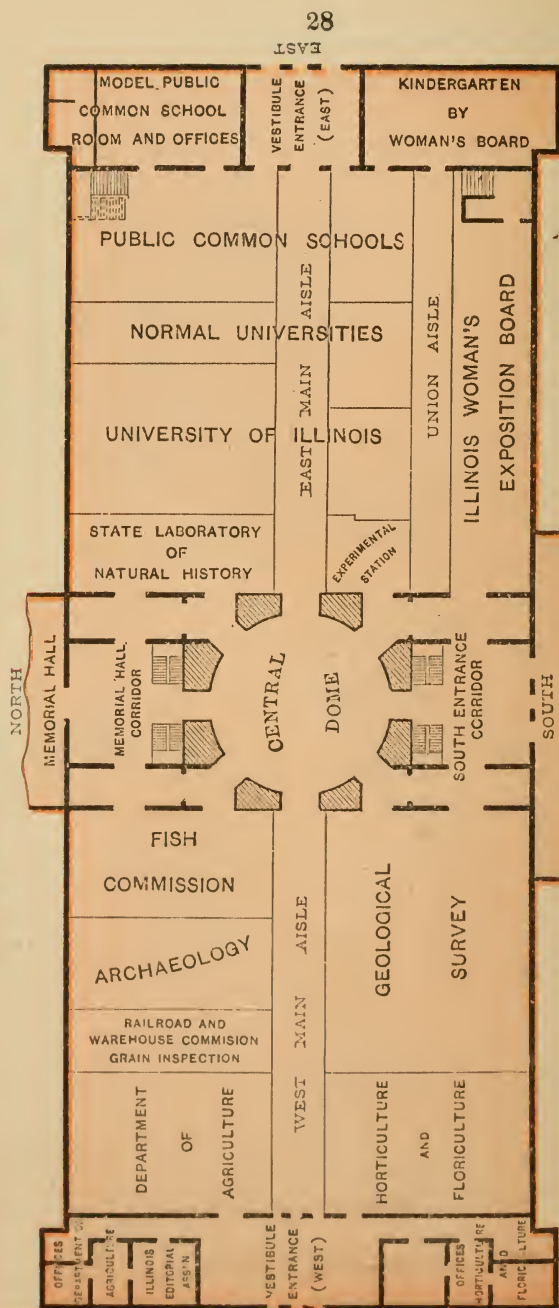

**GROUND PLAN ILLINOIS STATE BUILDING.**

**OTIS BROTHERS & CO., NEW YORK.**

**HAIR ELEVATOR**

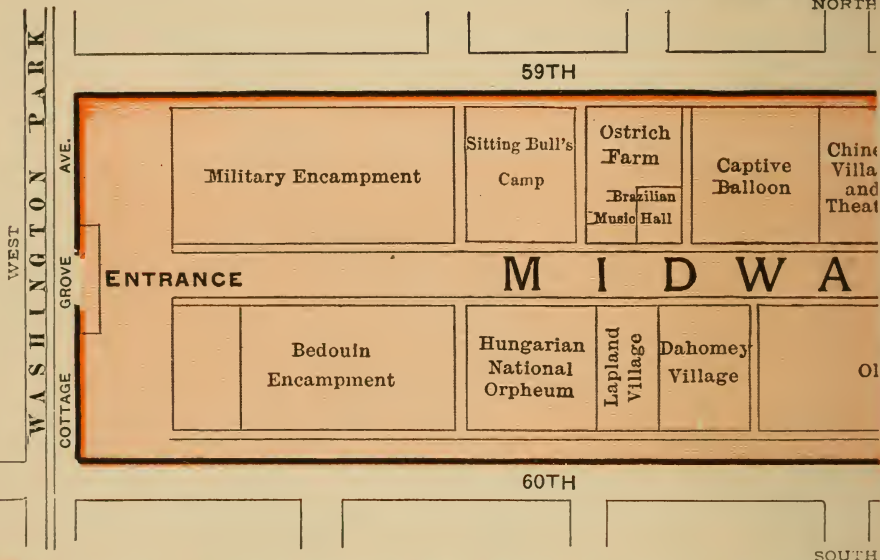

WEST HALF OF  
NORTH

**O** OTIS ELEVATORS IN THE EIFFEL TOWER,  
EAST HALF OF MIDWAY





## MIDWAY PLAISANCE.

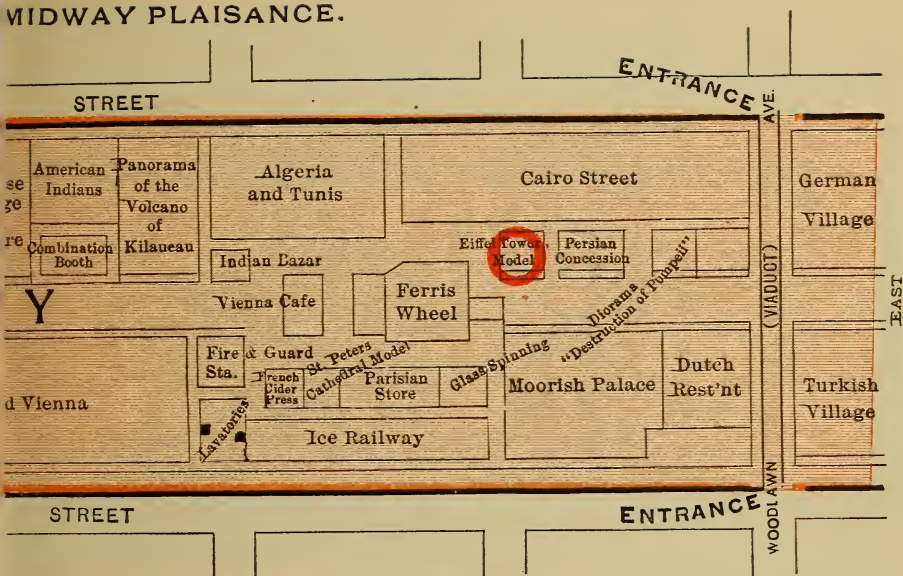

PARIS—SEE MODEL IN MIDWAY PLAISANCE.

## MIDWAY PLAISANCE.

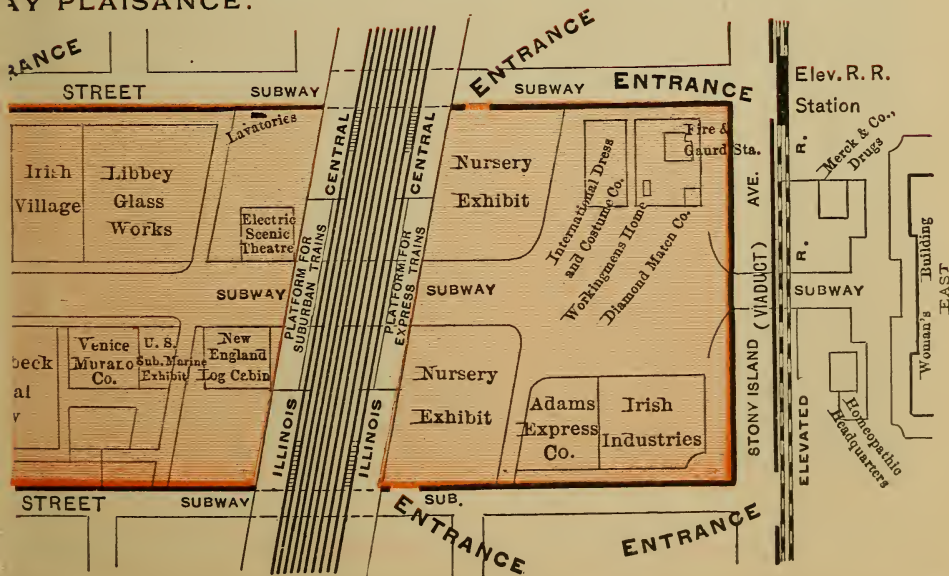



CATSKILL MOUNTAIN INCLINE RAILWAY.

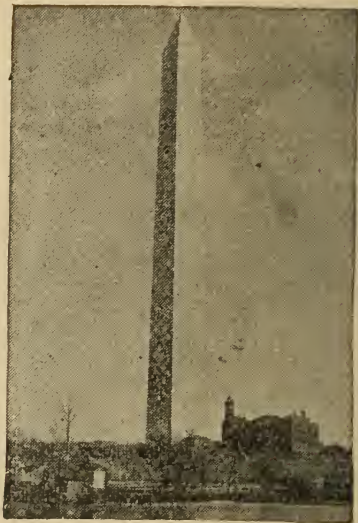

WASHINGTON MONUMENT.  
ONE OTIS ELEVATOR.

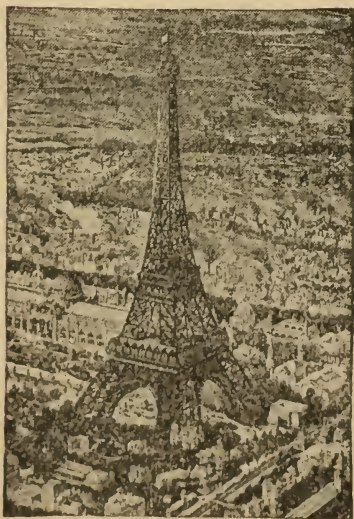

EIFFEL TOWER, PARIS.  
TWO OTIS ELEVATORS.

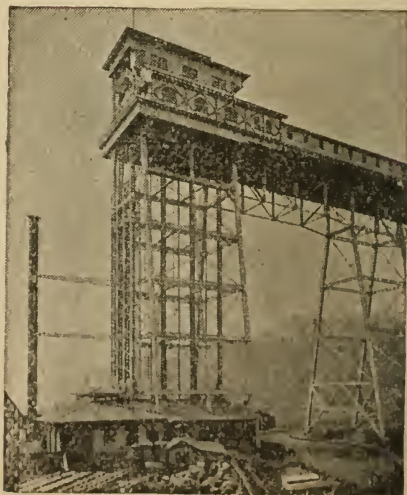

NORTH HUDSON COUNTY RAILWAY,  
WEBB HAWKEN, N. J.  
THREE OTIS ELEVATORS.

**CONSTRUCTED AND ERECTED BY**  
**OTIS BROTHERS & CO., NEW YORK, U. S. A.**

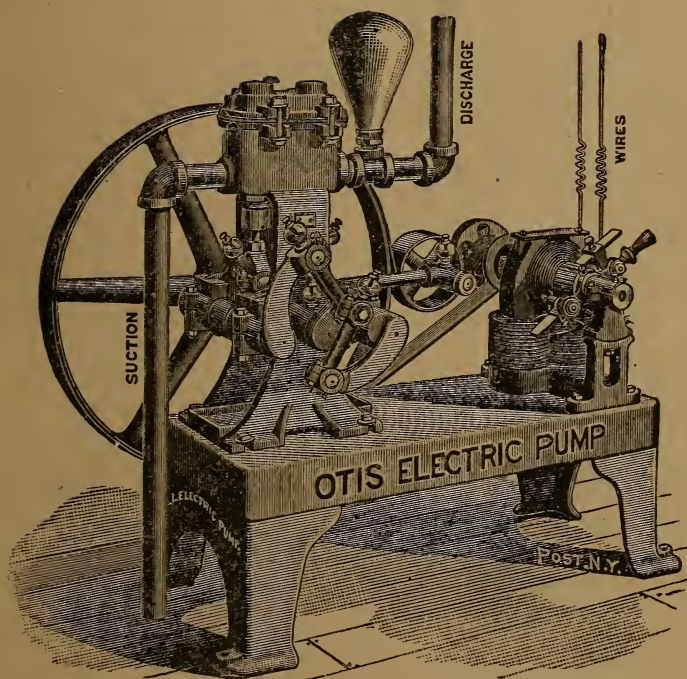

**OTIS ELECTRIC PUMP.**



THE FINEST VIEW TO BE HAD ON THE FAIR GROUNDS.

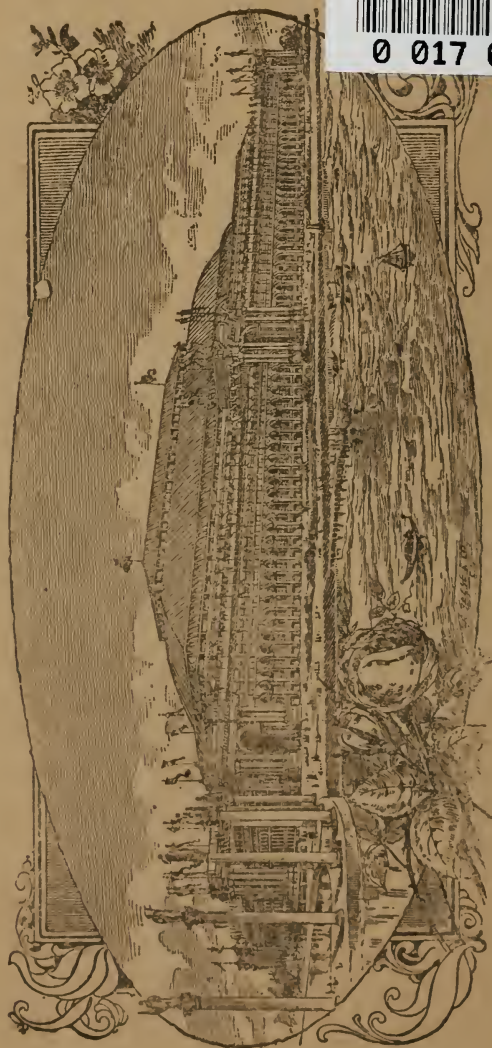

FOUR OTIS-HALE ELECTRIC ELEVATORS TO R  
PROMENADE. MIDDLE AISLE, NORTH.

LIBRARY OF CONGRESS



0 017 667 339 4